

VLB-44X

Long range lantern 6-14 NM (1-3 tiers)

The VLB-44X lantern forms part of the LED marine lantern family. The use of highly efficient optics and electronics has resulted in state-of-the-art energy efficiency.

This level of efficiency significantly reduces the solar panel and battery requirements in standalone applications.

- Comes in 3 different vertical divergences to cover both fixed and floating applications: 10° (ideal for buoys), 5° (for land/pole use), 2.5° (for lighthouses)
- With 1 to 3 tiers, can be sized to match the range requirement of a particular application. Multiple units can be used to extend the range to 16 NM
- Available colours are red, green, white and yellow
- The unique optical system utilises an acrylic lens to maximise the light captured from the LED's
- The LED's are precisely graded and placed to produce a light beam with minimum variation in intensity
- A switch mode regulator maintains the light output of the LEDs independent of input of voltage and temperature



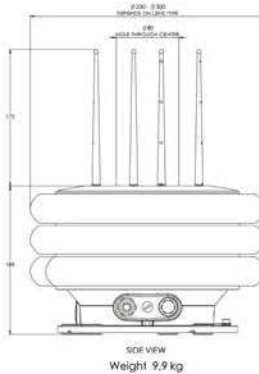
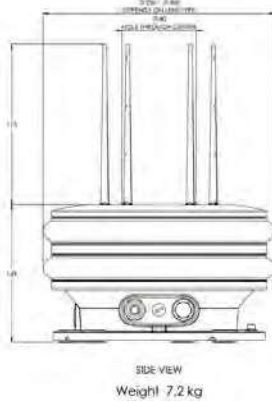
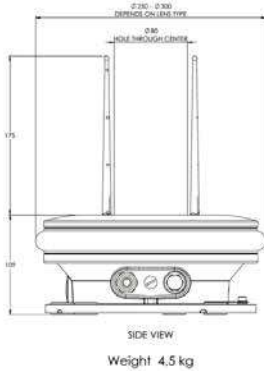
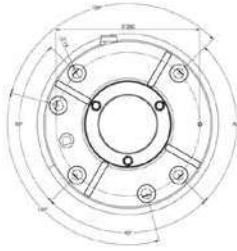

Optical Performance

Maximum intensity (Single tier)

10°	920 cd	1300 cd	1050 cd	1650 cd
5°	1400 cd	1800 cd	1500 cd	2610 cd
2.5°	2060 cd	2610 cd	2190 cd	3730 cd

Maximum intensity (Two tier)

10°	1840 cd	2600 cd	2100 cd	3300 cd
5°	2800 cd	3600 cd	4260 cd	5220 cd
2.5°	4120 cd	5220 cd	4380 cd	7460 cd

Maximum intensity (Three tier)

10°	2760 cd	3900 cd	3150 cd	4950 cd
5°	4200 cd	5400 cd	4500 cd	7830 cd
2.5°	6180 cd	7830 cd	6570 cd	11190 cd

Main Technical Specification

Light source	High-Intensity LEDs
Colours available	Red, Green, White, Yellow
Vertical divergence	2.5°@50% of peak 5°@50% of peak 10°@50% of peak
Weight	4.5 kg + 2.7 kg each additional tier
Temperature	-30° – +50°C
Voltage	12 VDC (10-18 VDC)
Intrusion protection	MIL-STD-202G Method 104A, Cond A P68, 1.5m for 60 minutes
Lens	Machined cast acrylic; UV-protected
Base	Marine grade aluminium
Degree of protection	IP 67
Cable length	2 m / 6 m

Order Overview VLB-44X

Product code

Code	Note
VLB44X-xT-cddd(-GS)	
c	Colour (R, G, Y, W)
ddd	Vertical divergence (2D5, 05D, 10D)
x	Tiers (1 to 3)

Option matrix

GS	GPS synchronization
VLB-44XE	Extended I/O